

**SVEN**<sup>®</sup>  
YOU WANT - WE CAN

Wireless Optical Mouse

# USER'S MANUAL



**RX-610**  
**WIRELESS**

[www.sven.fi](http://www.sven.fi)

***Congratulations on your purchase of the Sven mouse!***

Please read this Operation Manual before using the unit and retain this Operation Manual in a safe place for future reference.

**COPYRIGHT**

© 2014. SVEN PTE. LTD. Version 1.0 (V 1.0).

This Manual and information contained in it are copyrighted. All rights reserved.

**TRADEMARKS**

All trademarks are the property of their legal holders.

**NOTICE OF RESPONSIBILITY RESTRICTION**

Despite the exerted efforts to make this Manual more exact, some discrepancies may occur. The information of this Manual is given on "as is" terms. The author and the publisher do not bear any liability to a person or an organization for loss or damages which have arisen from the information contained in the given Manual.

**CONTENTS**

<b>1. SPECIAL FEATURES .....</b>	<b>2</b>
<b>2. PACKAGE CONTENTS .....</b>	<b>2</b>
<b>3. SYSTEM REQUIREMENTS .....</b>	<b>2</b>
<b>4. DESCRIPTION .....</b>	<b>3</b>
<b>5. INSTALLATION .....</b>	<b>3</b>
<b>6. TROUBLESHOOTING .....</b>	<b>6</b>
<b>7. TECHNICAL SPECIFICATIONS .....</b>	<b>6</b>

*Technical support is on [www.sven.fi](http://www.sven.fi)*

### 1. SPECIAL FEATURES

- RF2.4GHz USB nano receiver (range – up to 10 m)
- High-precision optical technology
- Operates practically on any surface
- High speed operation
- Resolution 1200 dpi
- USB interface
- Attractive glossy surface
- 2 AAA Alkaline type batteries
- Drivers installation is not required for Windows XP/Vista/7/8
- Energy saving system increases battery life up to 6 months (see comparison table)

Operating mode	RX-610 Wireless	Other mice
During work	4.8 — 6 mA	10 mA
Motionless	0.5 — 0.55 mA	8 mA
Standby mode	0.1 — 0.12 mA	3 mA
Sleep mode	0.03 — 0.05 mA	0.15 mA

### 2. PACKAGE CONTENTS

- Optical mouse — 1 pc
- 2.4 GHz USB nano receiver — 1 pc
- AAA type batteries — 2 pcs
- User's manual — 1 pc
- Warranty card — 1 pc

### 3. SYSTEM REQUIREMENTS

- Windows XP/Vista/7/8 or higher, Mac OS 10.4 or higher, Linux
- Free USB port

**4. DESCRIPTION**

- ① Scroll wheel
- ② Optical sensor
- ③ Battery compartment
- ④ Nano receiver
- ⑤ Connector USB

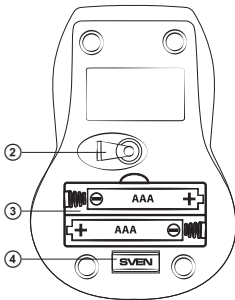

Fig. 2. Bottom view

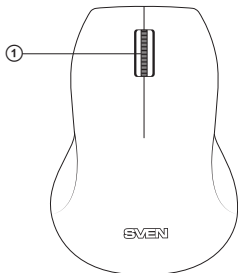

Fig. 1. Top view

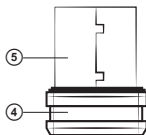

Fig. 3. Nano receiver

**5. INSTALLATION**

- Open the cover of the mouse battery compartment ③, insert two AAA type batteries into the battery compartment matching polarity, and close the cover of the battery compartment (see Fig. 4).
- Pull out the nano receiver ④ from the mouse (Fig. 5) and connect it to a free PC USB port without switching off the PC (Fig. 6). To activate the mouse, press any button of the mouse or turn the scroll wheel. If the mouse has been connected correctly, it will turn on automatically.

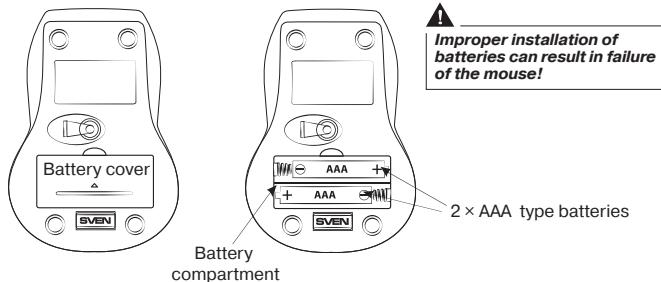

Fig. 6. Receiver connection

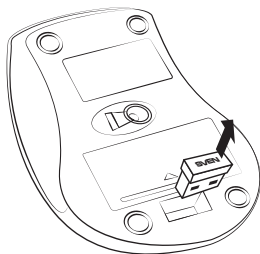

Fig. 5. Extraction of the receiver from the mouse case

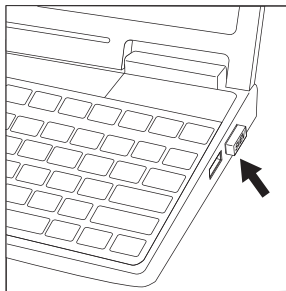
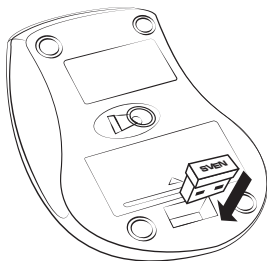

Fig. 6. Receiver connection

- After finishing work, the receiver can be pulled out from the PC USB port and inserted back into the mouse (Fig. 7).
- Do not place the receiver in a metal confined space (table drawer, box, safe), as metal screen does not transmit radio signals.
- If the batteries run down, the mouse works by fits. It means that batteries should be replaced with new ones, as it is shown in Fig. 4. Always install only identical new batteries.



*Fig. 7. Fitting the receiver  
into the mouse case*

**! Important**

- ***This device meets highest standards of energy conservation. During long pauses in operation the mouse enters economical Sleep mode. To enter working mode just press any button or turn the scroll wheel.***

## 6. TROUBLESHOOTING

Problem	Solution
The mouse does not work.	<ol style="list-style-type: none"> <li>1. Make sure that the nano receiver has been inserted into a USB port and its distance to the mouse is less than 10 m.</li> <li>2. Check whether the batteries have been installed correctly.</li> <li>3. Check if the batteries have run down, replace the batteries with new ones if necessary.</li> <li>4. Address nearest authorized service center.</li> </ol>

## 7. TECHNICAL SPECIFICATIONS

Parameter	Value
OS required	Windows XP/Vista/7/8
Type of mouse	Wireless 2.4 GHz
Resolution, dpi	1200
Q-ty of buttons	2 + 1 (scroll wheel)
Interface	USB
Dimensions, mm	70 × 42 × 108
Weight, g	60

### Notes:

- **Technical specifications given in this table are supplemental information and cannot give occasion to claims.**
- **Technical specifications are subject to change without notice due to the improvement of SVEN production.**

## Wireless Optical Mouse

**SVEN**<sup>®</sup>  
YOU WANT - WE CAN



Модель: **RX-610 Wireless**

Импортер в России: ООО «СКАНДИТРЕЛ», 111024, РФ, г. Москва, ул. Авиамоторная, д. 65, стр. 1.

Уполномоченная организация в России:

ООО «РТ-Ф», 105082, г. Москва, ул. Фридриха Энгельса, д. 75, стр. 5.

Условия гарантийного обслуживания смотрите в гарантийном талоне или на сайте **www.sven.fi**.

Гарантийный срок: 12 мес. Срок службы: 2 года.

Производитель: «СВЕН ПТЕ. Лимитед», 176 Джу Чиат Роуд, № 02-02, Сингапур, 427447.

Произведено под контролем «Свен Скандинавия Лимитед», 48310, Финляндия, Котка, Котолахдентие, 15. Сделано в Китае.

Manufacturer: SVEN PTE. LTD, 176 Joo Chiat Road, № 02-02, Singapore, 427447. Produced under the control of Oy Sven Scandinavia Ltd. 15, Kotolahdentie, Kotka, Finland, 48310. Made in China.

© **Registered Trademark of Oy SVEN Scandinavia Ltd. Finland.**

**RX-610  
WIRELESS**