

SVEN[®]
YOU WANT - WE CAN

Wireless Optical Mouse

USER'S MANUAL



RX-420W

www.sven.fi

Congratulations on purchasing the SVEN PC mouse!

Please read the following User's Manual carefully before connecting, operating or adjusting this product. Besides, please keep this Manual in a safe place for future reference.

COPYRIGHT

© 2014. SVEN PTE. LTD. Version 1.0 (V 1.0).

This Manual and information contained in it are copyrighted. All rights reserved.

TRADEMARKS

All trademarks are the property of their legal holders.

NOTICE OF RESPONSIBILITY RESTRICTION

Despite the exerted efforts to make this Manual more exact, some discrepancies may occur. The information of this Manual is given on «as is» terms. The author and the publisher do not bear any liability to a person or an organization for loss or damages which have arisen from the information contained in the given Manual.

СОДЕРЖАНИЕ

1. SPECIAL FEATURES	2
2. PACKAGE CONTENTS	2
3. SYSTEM REQUIREMENTS	2
4. DESCRIPTION	3
5. INSTALLATION	3
6. TROUBLESHOOTING	6
7. TECHNICAL SPECIFICATION	6

Technical support: www.sven.fi

1. SPECIAL FEATURES

- RF2.4GHz USB Nano-receiver (range – up to 10 m)
- High-precision optical technology. Effective on most surfaces
- High speed operation
- 4 + 1 buttons
- Scroll wheel
- Resolution 1000 dpi
- Interface USB
- 2 AAA Alkaline type batteries
- Rubberized casing mouse
- Drivers installation not required for Windows XP/Vista/7/8
- Convenient for both right and left hands
- The perfect energy system increases the work of the battery up to 6 months (see comparison table)

Operating mode	RX-420W	Other mouses
During work	48 — 6 mA	10 mA
Motionless	0.5 — 0.55 mA	8 mA
Standby mode	0.1 — 0.12 mA	3 mA
Sleeping mode	0.03 — 0.05 mA	0.15 mA

2. PACKAGE CONTENTS

- Optical mouse — 1 pc
- 2.4 GHz USB Nano-receiver — 1 pc
- AAA type batteries — 2 pcs
- User's manual — 1 pc
- Warranty card — 1 pc

3. SYSTEM REQUIREMENTS

- Windows XP/Vista/7/8, Mac OS 10.4 or higher, Linux
- Free USB port

4. DESCRIPTION

- ① Scroll wheel
- ② Additional buttons
- ③ Optical sensor
- ④ Battery compartment
- ⑤ Nano-receiver
- ⑥ Connector USB

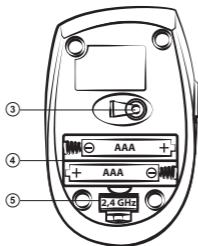

Fig. 2. Bottom view

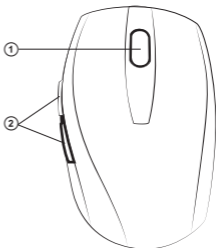

Fig. 1. Top view

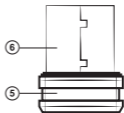

Fig. 3. Nano-receiver

5. INSTALLATION

- Open cover of the mouse battery compartment ④, insert two AAA type batteries into the battery compartment matching polarity, and close the cover of the battery compartment (see Fig. 4).
- Pull out Nano-receiver ⑤ from mouse (Fig. 5) and connect it to a free PC USB port not switching off the PC (Fig. 6). For mouse activation it is necessary to press any button of the mouse or turn the scroll wheel. If mouse has been connected correctly, it will turn on automatically.

Wireless Optical Mouse

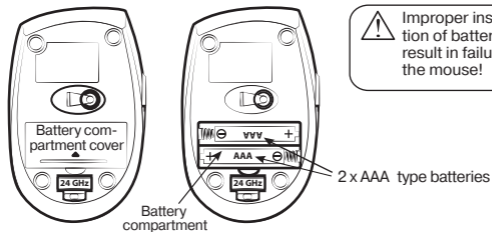

Fig. 4. Battery installation



Fig. 5. Extraction of the receiver from the mouse case

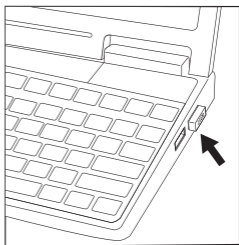
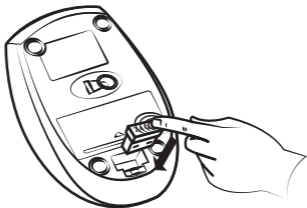

Fig. 6. Receiver connection

- After finishing work, receiver can be pulled out from PC USB port and inserted back into mouse (Fig. 7).
- Do not place receiver in a metal confined space (drawer of the table, box, safe), as metal screen does not transmit radio signals.
- If batteries run down, mouse works in fits and starts. It means that batteries should be changed for new ones, as it is shown in Fig. 4. Always install only new and same batteries.



*Fig. 7. Setting of receiver
in the corps of mouse*

! Important

- This device meets highest standards of energy conservation. During long pauses in mouse operation it enters economical sleeping mode. To enter working mode just press any button or turn the scroll wheel.

6. TROUBLESHOOTING

Problem	Solution
Mouse is not working.	1. Make sure that Nano-receiver has been inserted into USB port and its distance to mouse does not exceed 10 m. 2. Check whether batteries have been installed correctly. 3. Check whether batteries have not run down, change batteries for new ones if necessary.
Batteries are in good order, but mouse still is not working.	Install software to coordinate mouse and receiver. Software can be downloaded from «Support» on www.sven.fi

7. TECHNICAL SPECIFICATION

Parameter	Value
OS required	Windows XP/Vista/7/8
Type of mouse	Wireless 2.4 GHz
Resolution	1000 dpi
Q-ty of buttons	4 + 1
Interface	USB
Conformity with	FCC, CE

Notes:

- **Technical specification given in this table is supplemental information and can not give occasion to claims.**
- **Technical specification is subject to change without notice due to improvement of SVEN production.**

Wireless Optical Mouse

SVEN[®]
YOU WANT – WE CAN



Модель: **RX-420 Wireless**

Импортер в России: ООО «СКАНДИТРЕЛ», 111024, РФ, г. Москва, ул. Авиамоторная, д. 65, стр. 1.

Уполномоченная организация в России:

ООО «РТ-Ф», 105082, г. Москва, ул. Фридриха Энгельса, д. 75, стр. 5.

Условия гарантийного обслуживания смотрите в гарантийном талоне или на сайте **www.sven.fi**.

Гарантийный срок: 12 мес. Срок службы: 2 года.

Производитель: «СВЕН ПТЕ. Лимитед», 176 Джу Чиат Роуд, № 02-02, Сингапур, 427447.

Произведено под контролем «Свен Скандинавия Лимитед», 48310, Финляндия, Котка, Котолахдентие, 15. Сделано в Китае.

Manufacturer: SVEN PTE. LTD., 176 Joo Chiat Road, № 02-02, Singapore, 427447. Produced under the control of Oy Sven Scandinavia Ltd. 15, Kotolahdentie, Kotka, Finland, 48310. Made in China.

© Registered Trademark of Oy SVEN Scandinavia Ltd. Finland.

RX-420W