

SVEN[®]
YOU WANT - WE CAN

Wireless Optical Mouse

USER'S MANUAL



**RX-345
WIRELESS**

www.sven.fi

Congratulations on your purchase of the Sven mouse!

Please read this Operation Manual before using the unit and retain this Operation Manual in a safe place for future reference.

COPYRIGHT

© 2016. SVEN PTE. LTD. Version 1.0 (V 1.0).

This Manual and information contained in it are copyrighted. All rights reserved.

TRADEMARKS

All trademarks are the property of their legal holders.

NOTICE OF RESPONSIBILITY RESTRICTION

Despite the exerted efforts to make this Manual more exact, some discrepancies may occur. The information of this Manual is given on “as is” terms. The author and the publisher do not bear any liability to a person or an organization for loss or damages which have arisen from the information contained in the given Manual.

CONTENTS

| | |
|--|----------|
| 1. SPECIAL FEATURES | 2 |
| 2. PACKAGE CONTENTS | 3 |
| 3. SYSTEM REQUIREMENTS | 3 |
| 4. DESCRIPTION | 4 |
| 5. INSTALLATION | 4 |
| 6. TROUBLESHOOTING | 7 |
| 7. TECHNICAL SPECIFICATIONS | 7 |

Technical support is on www.sven.fi.

1. SPECIAL FEATURES

- 2.4 GHz USB Nano receiver included (range – up to 10 m)
- Resolution 600/1000/1400 dpi
- DPI resolution switch
- Two additional navigation buttons (Forward and Back)
- USB interface
- Soft Touch coating
- 2 AAA Alkaline type batteries
- Long life battery-fed operation (1 year)
- Drivers installation is not required for Windows XP/Vista/7/8/10

2. PACKAGE CONTENTS

- Optical mouse — 1 pc
- 2.4 GHz USB Nano receiver — 1 pc
- AAA type batteries — 2 pcs
- User's Manual — 1 pc
- Warranty card — 1 pc

3. SYSTEM REQUIREMENTS

- Windows XP/Vista/7/8/10.
- Free USB port.

4. DESCRIPTION

- ① Scroll wheel
- ② DPI switch
- ③ Forward and Back navigation buttons
- ④ Optical sensor
- ⑤ Battery compartment
- ⑥ Nano receiver
- ⑦ Connector USB
- ⑧ ON/OFF: power switch

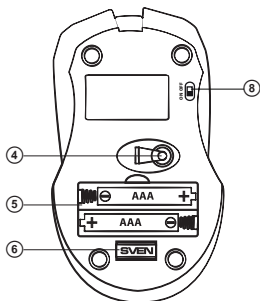

Fig. 2. Bottom view

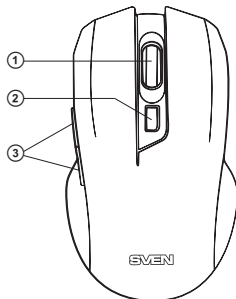

Fig. 1. Top view

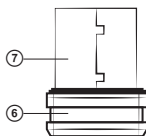

Fig. 3. Nano receiver

5. INSTALLATION

- Open the cover of the mouse battery compartment ⑤, insert two AAA type batteries into the battery compartment, matching polarity, and close the cover of the battery compartment (see Fig. 4).
- Pull out the nano receiver ⑥ from the mouse (Fig. 5) and connect it to a free PC USB port without switching off the PC (Fig. 6).
- Turn on the mouse with the on/off switch ⑧ (the ON position). To activate the mouse, press any button of the mouse or turn the scroll wheel. If the mouse has been connected correctly, it will turn on automatically.

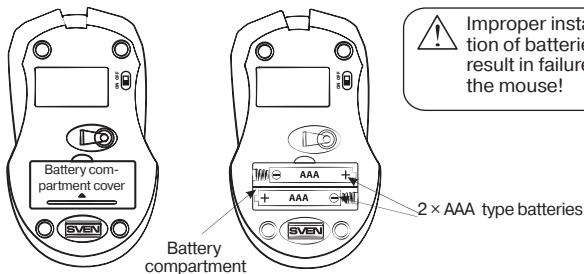

Fig. 4. Batteries installation

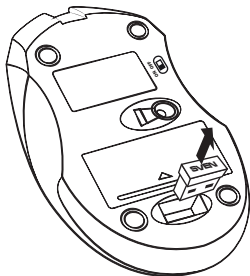

Fig. 5. Extraction of the receiver from the mouse case

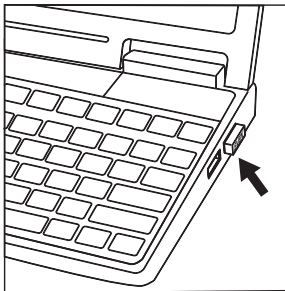

Fig. 6. Receiver connection

- After finishing work turn off the mouse with the power switch ⑧ (the OFF position). After that the receiver can be pulled out from the PC USB port and inserted back into the mouse (Fig. 7).
- Do not place the receiver in a metal confined space (table drawer, box, safe), as metal screen does not transmit radio signals.
- If the batteries run down, the mouse works in jerks. It means that batteries should be replaced with new ones, as it is shown in Fig. 4. Always install only identical new batteries.

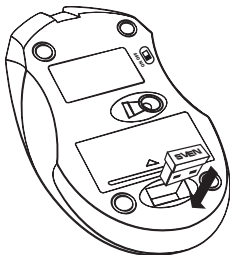

Fig. 7. Fitting the receiver
into the mouse case

! Important

- ***This device meets the highest standards of energy conservation. Use the switch ⑧ on the bottom of the mouse to switch it on/off – it will help you extend the mouse battery life.***

6. TROUBLESHOOTING

| Problem | Solution |
|--------------------------|--|
| The mouse does not work. | <ol style="list-style-type: none"> 1. Make sure that the nano receiver has been inserted into a USB port and its distance to the mouse is less than 10 m. 2. Check whether the batteries have been installed correctly. 3. Check if the batteries have run down, replace the batteries with new ones if necessary. 4. Address nearest authorized service center. |

7. TECHNICAL SPECIFICATIONS

| Parameter | Value |
|------------------|-------------------------|
| OS compatibility | Windows XP/Vista/7/8/10 |
| Type of mouse | Wireless 2.4 GHz |
| Resolution, dpi | 600/1000/1400 |
| Q-ty of buttons | 5 + 1 (scroll wheel) |
| Interface | USB |
| Dimensions, mm | 66 × 33 × 100 |
| Weight, g | 80 |

Notes:

- **Technical specifications given in this table are supplemental information and cannot give occasion to claims.**
- **Technical specifications are subject to change without notice due to the improvement of SVEN production.**

Wireless Optical Mouse

SVEN[®]
YOU WANT - WE CAN



Model: RX-345 Wireless

Импортер в России: ООО «РЕГАРД», 109052,
РФ, г. Москва, ул. Нижегородская, д. 86, корп. Б.
Уполномоченная организация в России:
ООО «РТ-Ф», 105082, г. Москва, ул. Фридриха
Энгельса, д. 75, стр. 5.

Условия гарантийного обслуживания смотрите
в гарантийном талоне или на сайте www.sven.fi.
Гарантийный срок: 12 мес. Срок службы: 2 года.
Производитель: «СВЕН ПТЕ. Лимитед»,
176 Джу Чиат Роуд, № 02-02, Сингапур, 427447.
Произведено под контролем «Свен Скандинавия
Лимитед», 48310, Финляндия, Котка,
Котolahdentie, 15. Сделано в Китае.

Manufacturer: SVEN PTE. LTD, 176 Joo Chiat Road,
№ 02-02, Singapore, 427447. Produced under the
control of Oy Sven Scandinavia Ltd. 15, Kotolahdentie,
Kotka, Finland, 48310. Made in China.

© Registered Trademark of Oy SVEN
Scandinavia Ltd. Finland.

RX-345
WIRELESS