

SVEN[®]
YOU WANT - WE CAN

Wireless Optical Mouse

USER'S MANUAL



**RX-330
WIRELESS**

www.sven.fi

Congratulations on your purchase of the SVEN PC mouse!

Please read the following instructions carefully before connecting, operating or adjusting this product. Besides, please keep this Manual in a safe place for future reference.

COPYRIGHT

© 2014. SVEN PTE. LTD. Version 1.0 (V 1.0).

This Manual and information contained in it are copyrighted. All rights reserved.

TRADEMARKS

All trademarks are the property of their legal holders.

NOTICE OF RESPONSIBILITY RESTRICTION

Despite the exerted efforts to make this Manual more exact, some discrepancies may occur. The information in this Manual is given on «as is» terms. The author and the publisher do not bear any liability to a person or an organization for loss or damage which has arisen from the information contained in this Manual.

CONTENTS

1. SPECIAL FEATURES	2
2. PACKAGE CONTENTS	2
3. SYSTEM REQUIREMENTS	2
4. DESCRIPTION	3
5. INSTALLATION	3
6. TROUBLESHOOTING	6
7. TECHNICAL SPECIFICATIONS	6

Technical support is on www.sven.fi

1. SPECIAL FEATURES

- 2.4GHz USB nano receiver (range up to 10 m)
- High-precision optical technology
- Power efficient invisible sensor
- Effective on most surfaces
- High speed operation
- DPI resolution switch
- Optics construction prevents ingress of dust
- Resolution 1000/1600 dpi
- USB interface
- Powered by 2 AAA batteries
- Drivers installation is not required for Windows XP/Vista/7/8
- Soft Touch coating

2. PACKAGE CONTENTS

- Optical mouse — 1 pc
- 2.4 GHz USB nano receiver — 1 pc
- AAA battery — 2 pcs
- User's Manual — 1 pc
- Warranty card — 1 pc

3. SYSTEM REQUIREMENTS

- Windows XP/Vista/7/8.
- Free USB port.

4. DESCRIPTION

- ① Scroll wheel
- ② Dpi resolution switch
- ③ Battery compartment
- ④ Optical sensor
- ⑤ Nano receiver
- ⑥ USB connector

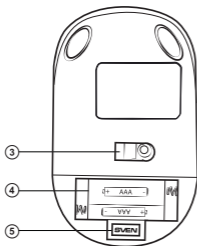

Fig. 2. Bottom view

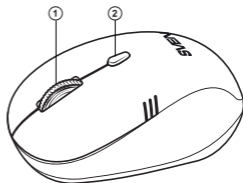

Fig. 1. Top view

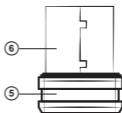

Fig. 3. Nano receiver

5. INSTALLATION

- Open the cover of the mouse battery compartment (④), insert 2 AAA batteries into the battery compartment matching the polarity, and close the cover of the battery compartment (see Fig. 4).
- Connect the included nano receiver (⑤) to a free PC USB port (Fig. 5).
- To activate the mouse, press any button of the mouse or turn the scroll wheel. If the mouse has been connected correctly, it will turn on automatically.

!
Improper installation of the batteries can result in failure of the mouse!

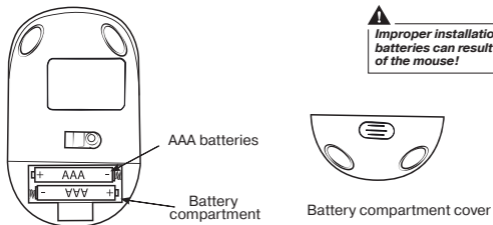

Fig. 4. Battery installation

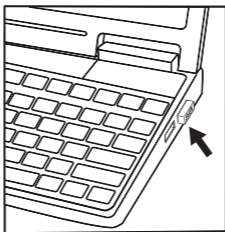

Fig. 5. Receiver connection

- After finishing your work, you can pull out the receiver ⑤ from the PC USB port and insert it into the mouse (Fig. 6). When using the receiver ⑤ again, pull it out from the mouse (Fig. 7) and connect it to the PC USB port again.
- Do not place the receiver into a confined metal space (table drawer, box, safe), as a metal screen does not transmit radio signals.
- If the batteries run down, the mouse works in jerks. It means that the batteries should be replaced with new ones, as it is shown in Fig. 4.

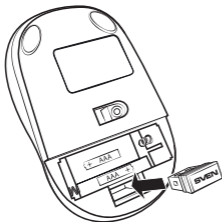

Fig. 6. Fitting the receiver into the mouse case

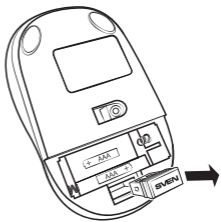

Fig. 7. Extraction of the receiver from the mouse case

⚠ Important

- ***This device meets highest standards of energy conservation. During long pauses in operation the mouse enters the economical Sleep mode. To enter the working mode just press any button or turn the scroll wheel.***

6. TROUBLESHOOTING

Problem	Solution
The mouse does not work.	1. Make sure that the nano receiver has been inserted into the USB port and its distance to the mouse is less than 10 m. 2. Check whether the batteries have been installed correctly. 3. Check if the batteries have run down, replace the batteries with new ones if necessary.
The batteries are in good order, but the mouse still does not work.	Install software to coordinate the mouse and the receiver. Software can be downloaded from Support on www.sven.fi

7. TECHNICAL SPECIFICATIONS

Parameter	Value
OS compatibility	Windows XP/Vista/7/8
Type of mouse	wireless 2.4 GHz
Resolution, dpi	1000/1600
Q-ty of buttons	3 + 1 (scroll wheel)
Interface	USB
Dimensions, mm	60 × 40 × 97
Weight, g	58

Notes:

- **Technical specifications given in this table are supplemental information and cannot give occasion to claims.**
- **Technical specifications are subject to change without notice due to the improvement of SVEN production.**

Wireless Optical Mouse

SVEN[®]
YOU WANT – WE CAN



Модель: RX-330 Wireless

Импортер в России: ООО «СКАНДИТРЕЛ», 111024, РФ, г. Москва, ул. Авиамоторная, д. 65, стр. 1.

Уполномоченная организация в России:
ООО «РТ-Ф», 105082, г. Москва, ул. Фридриха Энгельса, д. 75, стр. 5.

Условия гарантийного обслуживания смотрите в гарантийном талоне или на сайте **www.sven.fi**.

Гарантийный срок: 12 мес. Срок службы: 2 года.

Производитель: «СВЕН ПТЕ. Лимитед»,
176 Джу Чиат Роуд, № 02-02, Сингапур, 427447.

Произведено под контролем «Свен Скандинавия Лимитед», 48310, Финляндия, Котка, Котолахдентие, 15. Сделано в Китае.

Manufacturer: SVEN PTE. LTD., 176 Joo Chiat Road, № 02-02, Singapore, 427447. Produced under the control of Oy Sven Scandinavia Ltd. 15, Kotolahdentie, Kotka, Finland, 48310. Made in China.

© Registered Trademark of Oy SVEN
Scandinavia Ltd. Finland.

**RX-330
WIRELESS**