

SVEN[®]
YOU WANT - WE CAN

Wireless Optical Mouse

USER'S MANUAL



**RX-310
WIRELESS**

www.sven.fi

Congratulations on your purchase of the SVEN PC mouse!

Please read the following instructions carefully before connecting, operating or adjusting this product. Besides, please keep this Manual in a safe place for future reference.

COPYRIGHT

© 2014. SVEN PTE. LTD. Version 1.0 (V 1.0).

This Manual and information contained in it are copyrighted. All rights reserved.

TRADEMARKS

All trademarks are the property of their legal holders.

NOTICE OF RESPONSIBILITY RESTRICTION

Despite the exerted efforts to make this Manual more exact, some discrepancies may occur. The information in this Manual is given on "as is" terms. The author and the publisher do not bear any liability to a person or an organization for loss or damage which has arisen from the information contained in this Manual.

CONTENTS

| | |
|--|----------|
| 1. SPECIAL FEATURES | 2 |
| 2. PACKAGE CONTENTS | 2 |
| 3. SYSTEM REQUIREMENTS | 2 |
| 4. DESCRIPTION | 3 |
| 5. INSTALLATION | 3 |
| 6. TROUBLESHOOTING | 6 |
| 7. TECHNICAL SPECIFICATIONS | 6 |

Technical support is on www.sven.fi

1. SPECIAL FEATURES

- BlueLED advanced optical technology
- Power saving wireless technology
- Symmetric shape
- Effective on most surfaces
- High speed operation
- 2.4GHz USB nano receiver included (range up to 10 m)
- Resolution 1200 dpi
- USB interface
- Powered by AA battery
- Drivers installation is not required for Windows XP/Vista/7/8
- Symmetrical shape of the mouse
- Convenient for laptop operation

2. PACKAGE CONTENTS

- Optical mouse — 1 pc
- 2.4 GHz USB nano receiver — 1 pc
- AA battery — 1 pc
- User's Manual — 1 pc
- Warranty card — 1 pc

3. SYSTEM REQUIREMENTS

- Windows XP/Vista/7/8.
- Free USB port.

4. DESCRIPTION

- ① Scroll wheel
- ② Battery compartment
- ③ Optical sensor
- ④ Nano receiver
- ⑤ USB connector

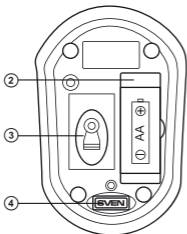

Fig. 2. Bottom view



Fig. 1. Top view

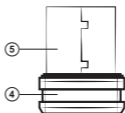

Fig. 3. Nano receiver

5. INSTALLATION

- Open the cover of the mouse battery compartment (2), insert the AA battery into the battery compartment matching the polarity, and close the cover of the battery compartment (see Fig. 4).
- Connect the included nano receiver (4) to a free PC USB port (Fig. 5). To activate the mouse, press any button of the mouse or turn the scroll wheel. If the mouse has been connected correctly, it will turn on automatically.

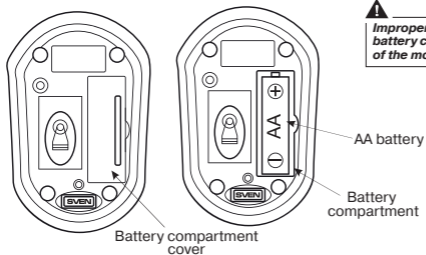

Fig. 4. Battery installation

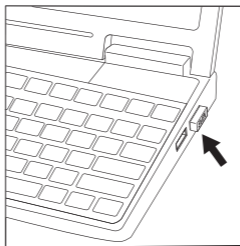

Fig. 5. Receiver connection

- After finishing your work, you can pull out the receiver ④ from the PC USB port and insert it into the mouse (Fig. 6). When using the receiver again, pull it out from the mouse (Fig. 7) and connect it to the PC USB port again.
- Do not place the receiver into a confined metal space (table drawer, box, safe), as a metal screen does not transmit radio signals.
- If the battery runs down, the mouse works by fits. It means that the battery should be replaced with a new one, as it is shown in Fig. 4.

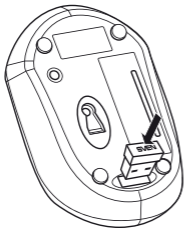

Fig. 6. Fitting the receiver into the mouse case

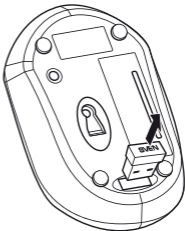

Fig. 7. Extraction of the receiver from the mouse case

⚠ Important

- **This device meets the highest standards of energy conservation. During long pauses in operation the mouse enters the economical Sleep mode. To enter the working mode just press any button or turn the scroll wheel.**

6. TROUBLESHOOTING

| Problem | Solution |
|--------------------------|---|
| The mouse does not work. | <ol style="list-style-type: none"> 1. Make sure that the nano receiver has been inserted into the USB port and its distance to the mouse is less than 10 m. 2. Check whether the battery has been installed correctly. 3. Check if the battery has run down, replace the battery with a new one if necessary. 4. Address nearest authorized service center. |

7. TECHNICAL SPECIFICATIONS

| Parameter | Value |
|------------------|----------------------|
| OS compatibility | Windows XP/Vista/7/8 |
| Type of mouse | wireless 2.4 GHz |
| Resolution, dpi | 1200 |
| Q-ty of buttons | 2 + 1 (scroll wheel) |
| Interface | USB |
| Dimensions, mm | 62 × 40 × 101 |
| Weight, g | 54.5 |

Notes:

- **Technical specifications given in this table are supplemental information and cannot give occasion to claims.**
- **Technical specifications are subject to change without notice due to the improvement of SVEN production.**

Wireless Optical Mouse

SVEN[®]
YOU WANT – WE CAN



Модель: **RX-310 Wireless**

Импортер в России: ООО «СКАНДИТРЕЛ», 111024, РФ, г. Москва, ул. Авиамоторная, д. 65, стр. 1.

Уполномоченная организация в России:

ООО «РТ-Ф», 105082, г. Москва, ул. Фридриха Энгельса, д. 75, стр. 5.

Условия гарантийного обслуживания смотрите в гарантийном талоне или на сайте **www.sven.fi**.

Гарантийный срок: 12 мес. Срок службы: 2 года.

Производитель: «СВЕН ПТЕ. Лимитед»,

176 Джу Чиат Роуд, № 02-02, Сингапур, 427447.

Произведено под контролем «Свен Скандинавия Лимитед», 48310, Финляндия, Котка,

Котолахдение, 15. Сделано в Китае.

Manufacturer: SVEN PTE. LTD., 176 Joo Chiat Road, № 02-02, Singapore, 427447. Produced under the control of Oy Sven Scandinavia Ltd. 15, Kotolahdentie, Kotka, Finland, 48310. Made in China.

® Registered Trademark of Oy SVEN Scandinavia Ltd. Finland.

**RX-310
WIRELESS**